

Application :

Wide range of the application such as bank, military, high grade computer room, top grade office, telecommunication room, power station, switchgear room, cleanroom and occasions which required high loading capacity and high request of anti-fire.

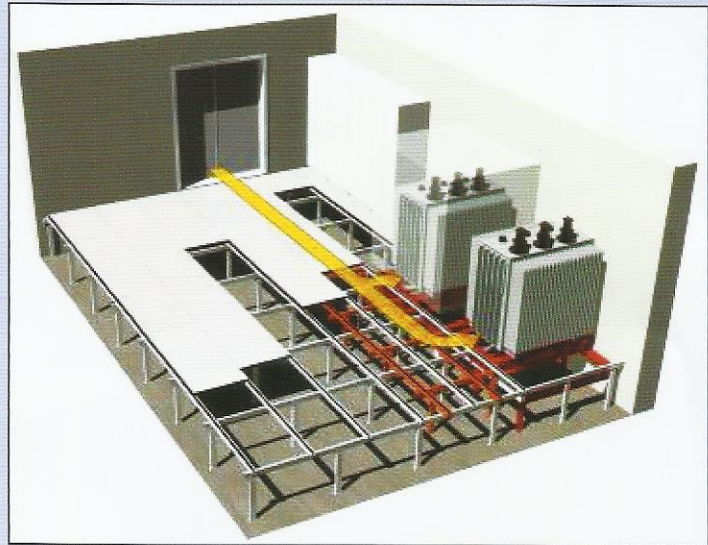

Features:

1. Good loading capacity, strong impact loading capacity and good conductivity.
2. Elaborated made, high dimension accuracy and excellent interchangeability.
3. Good sealing and water-proof.
4. Anti-fire. Fire retardant Class A1 (DIN 4102-1), Fire resistance rating Class A1 (DIN 4102-2).
5. Antisepsis and sound insulation.
6. Good decorative effect and comfortable when walking through.
7. Environmental friendly and free of pollution.

Specification:

Type	Concentrated Load (N)	Uniform Load (N/m ²)	Ultimate Load (N)	Rolling Load (N)		Impact Load (N)
				10 time	10000 time	
600x600x25 MM	≥3000	≥12500	≥9000	3000	2255	270
600x600x30 MM	≥4450	≥23000	≥13350	4450	3560	670
600x600x35/40 MM Heavy Duty	≥5560	≥33000	≥16680	5560	4450	670